

PROJET DE RÉNOVATION

SALLE DE BAIN

31200 TOULOUSE

I - ÉTAT DES LIEUX

01 - PHOTOS

02 - DÉMOLITIONS

II - PROJET

01 - PROPOSITIONS - Plan, Coupes / Élévations, Perspective

02 - DÉTAILS - mobilier en bois

III - MATÉRIAUX / AMBIANCE

01 - PLANCHE D'AMBIANCE

02 - RÉFÉRENCES

03 - MATÉRIAUX - Annexe tableau Excel -

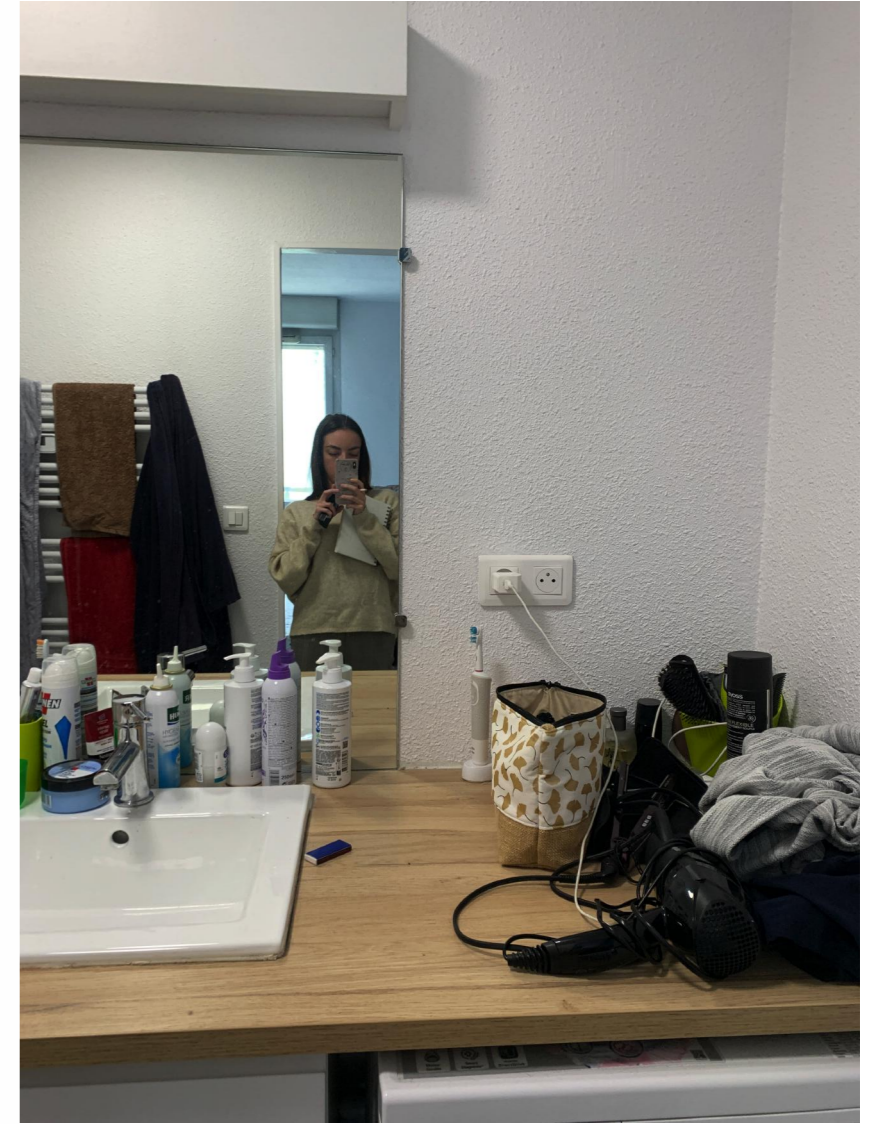
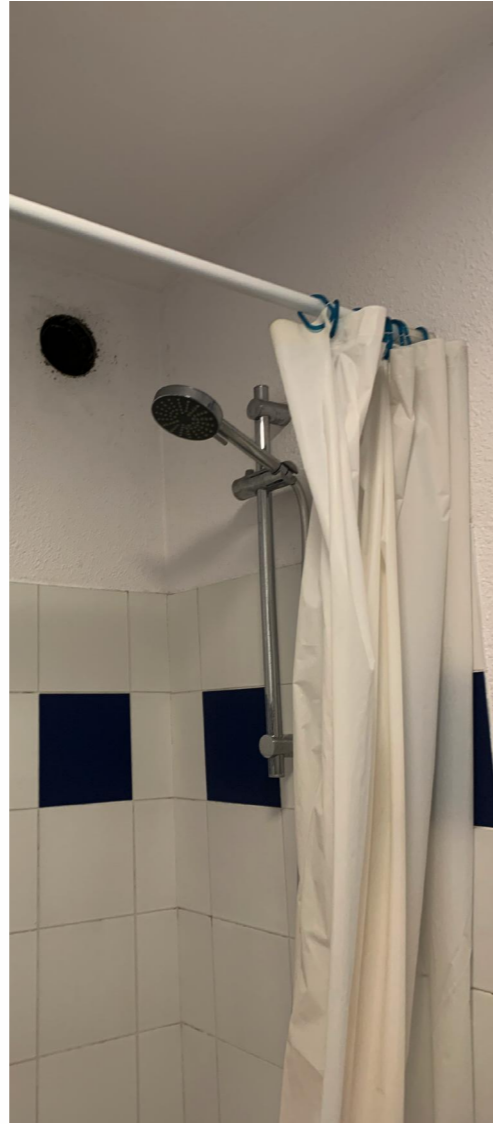

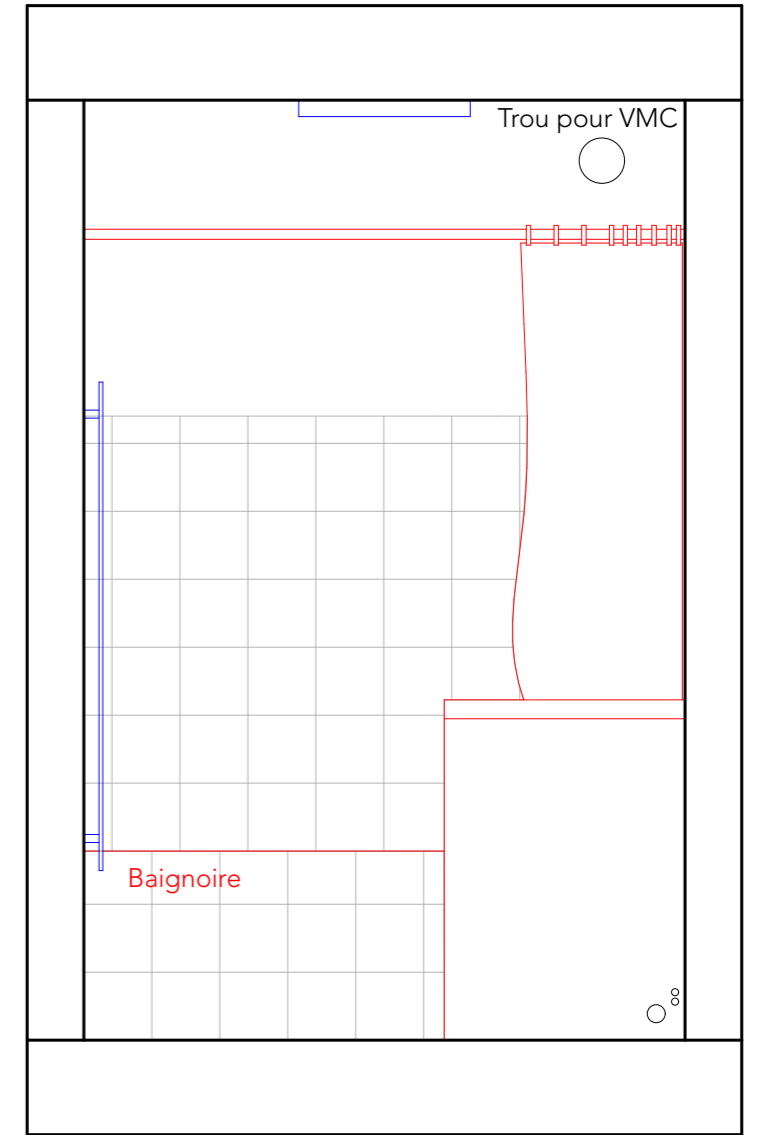
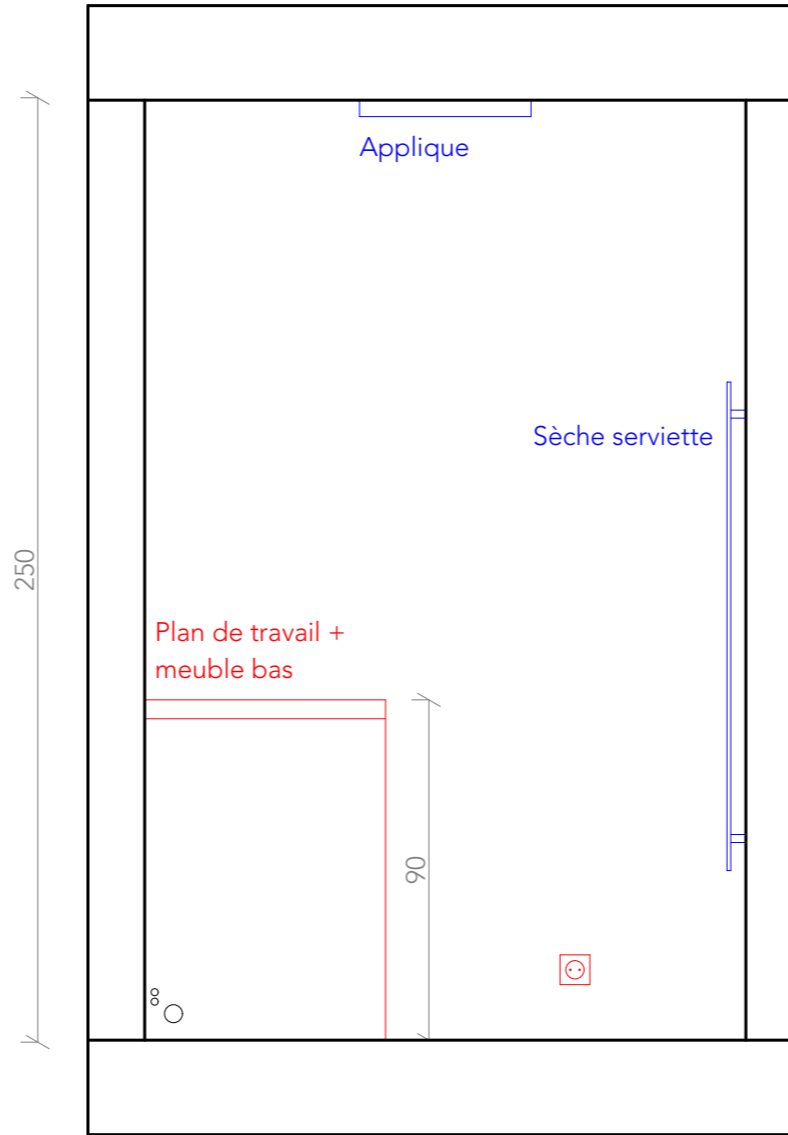
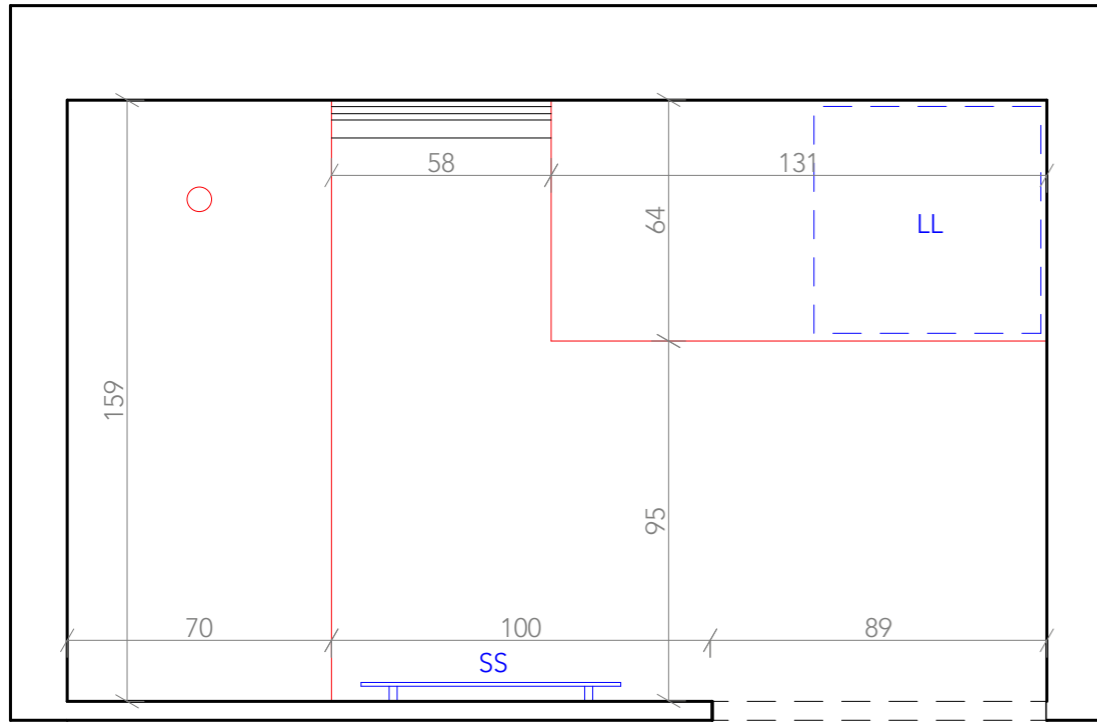

- Dépose
- Dépose / Repose

- Dépose
- Dépose / Repose

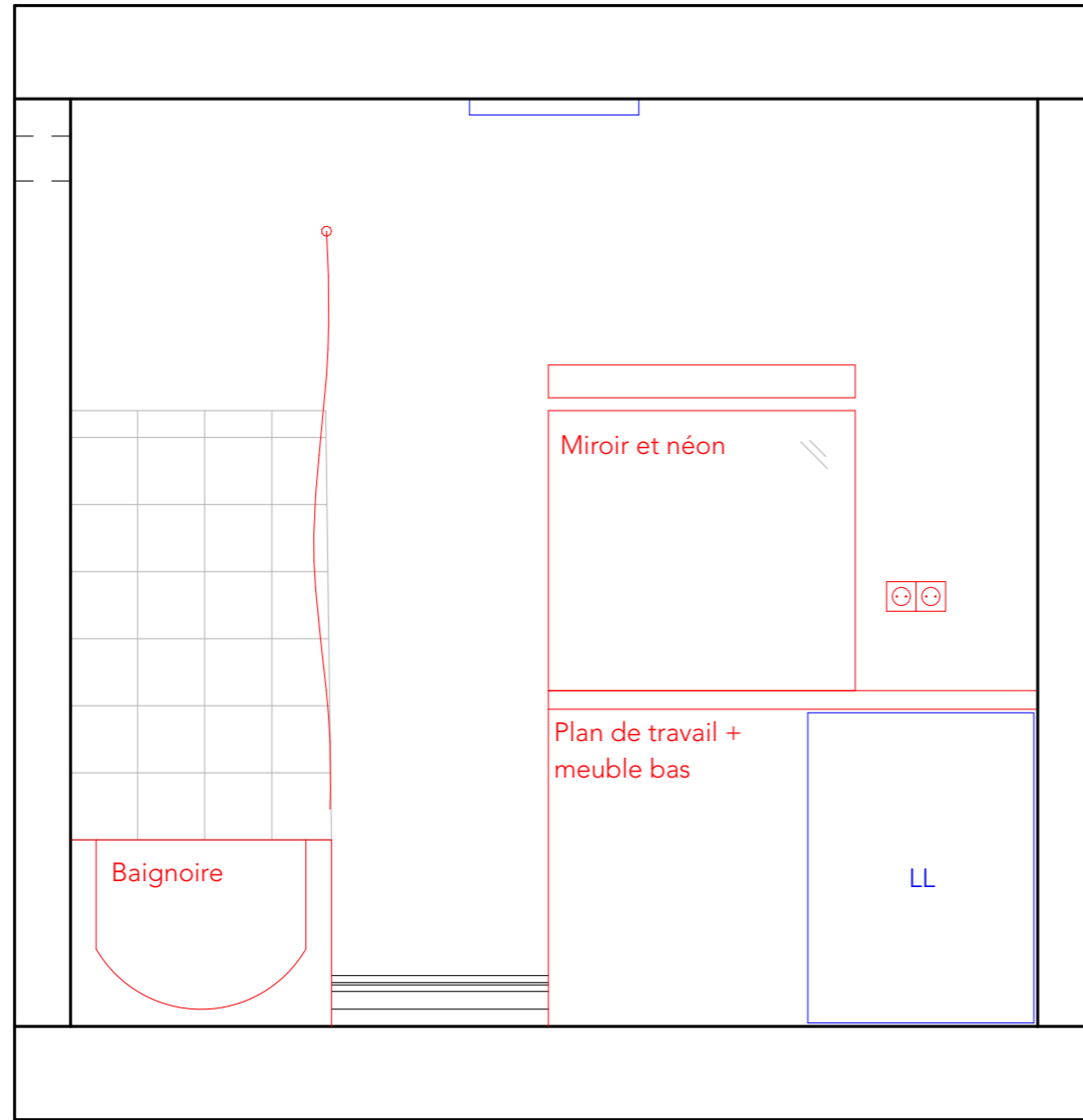

250
206

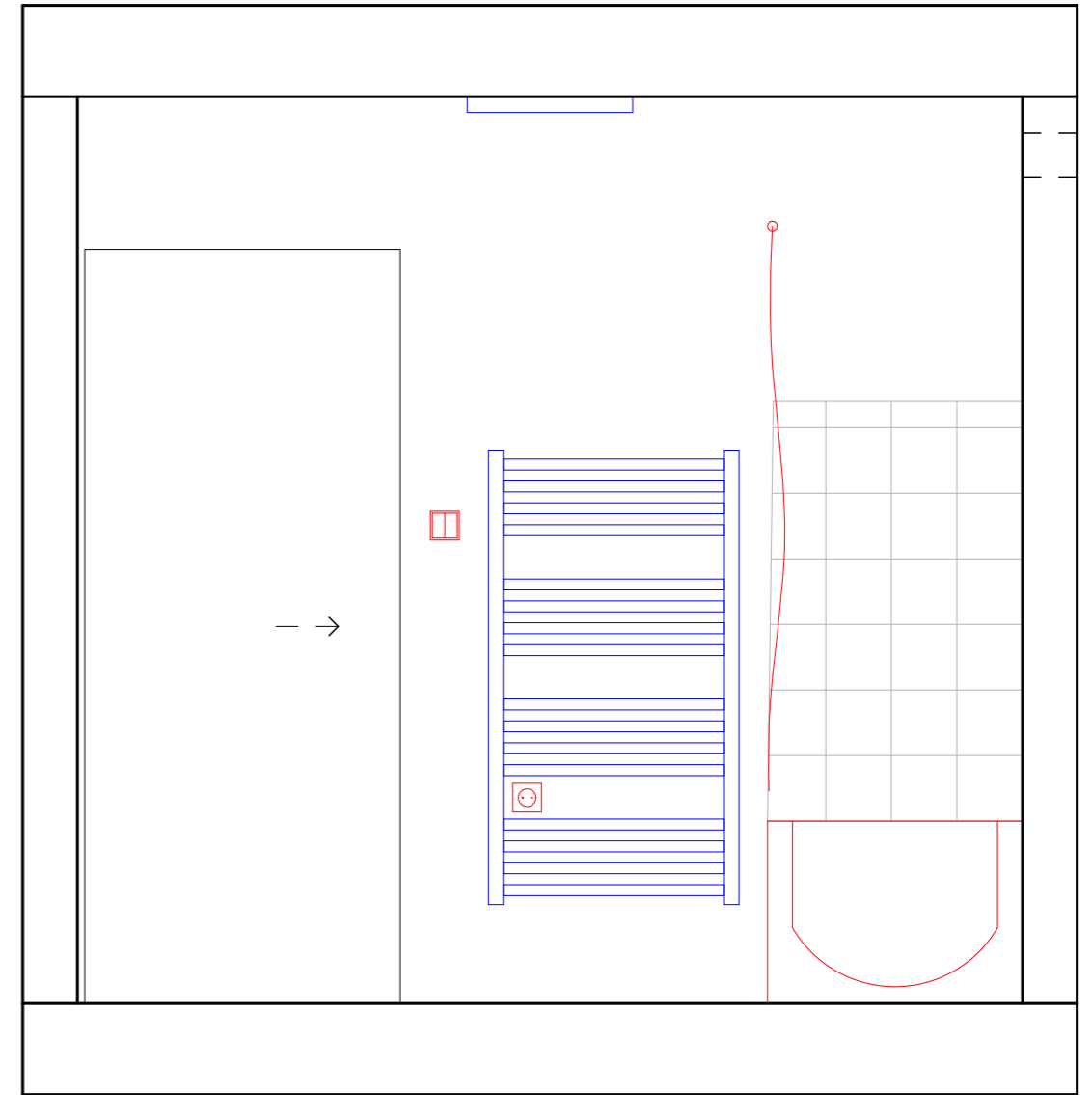

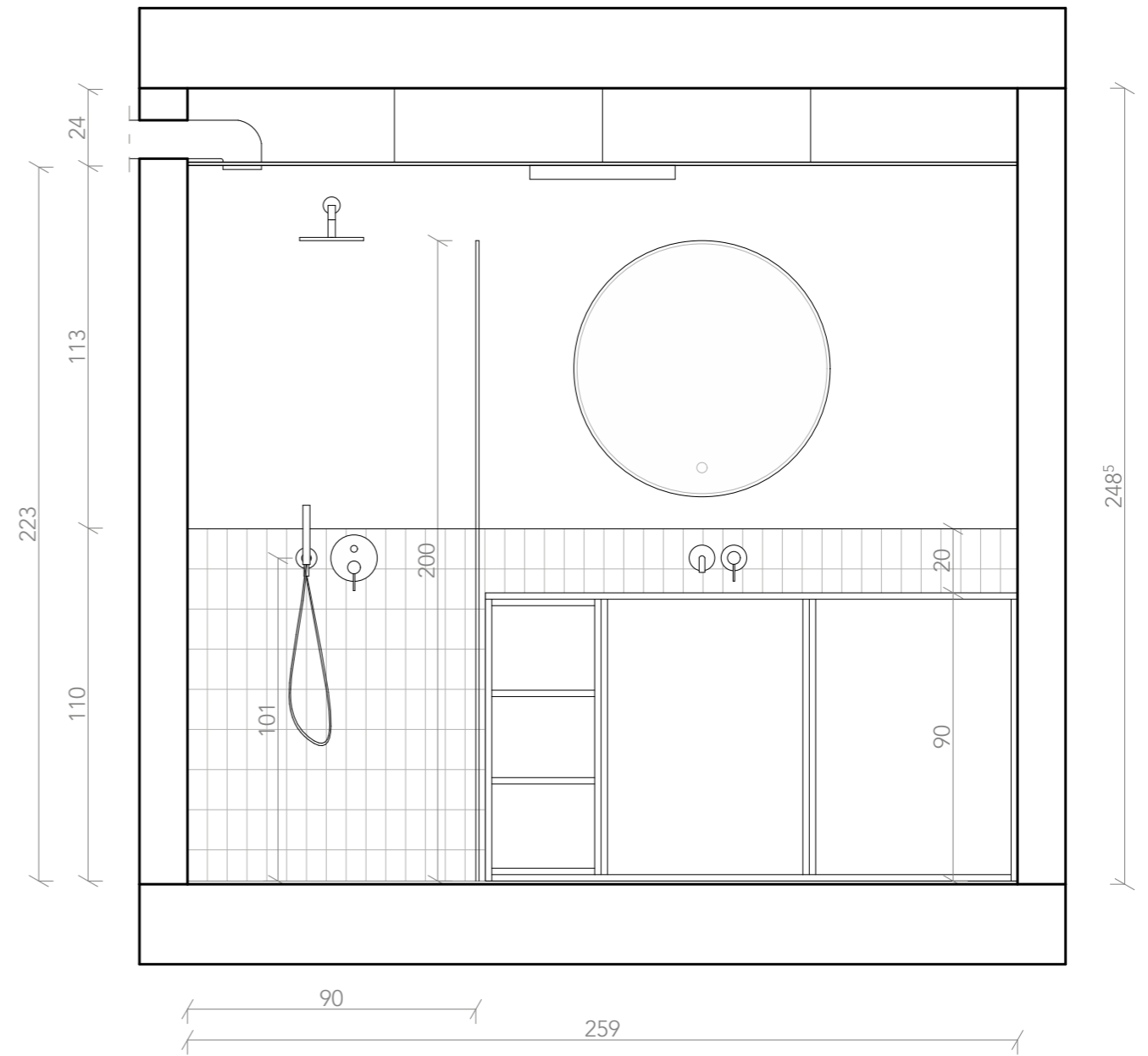
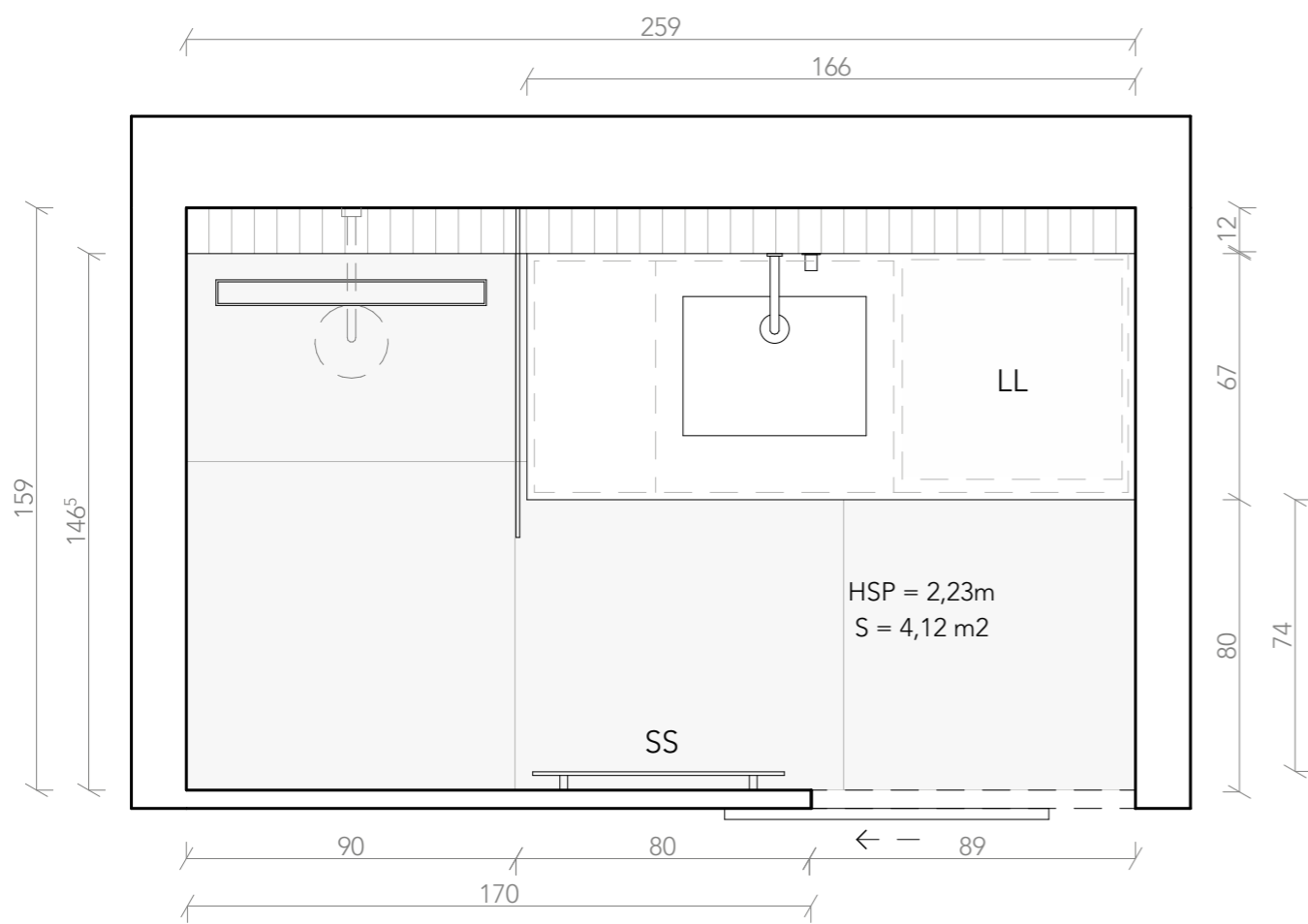

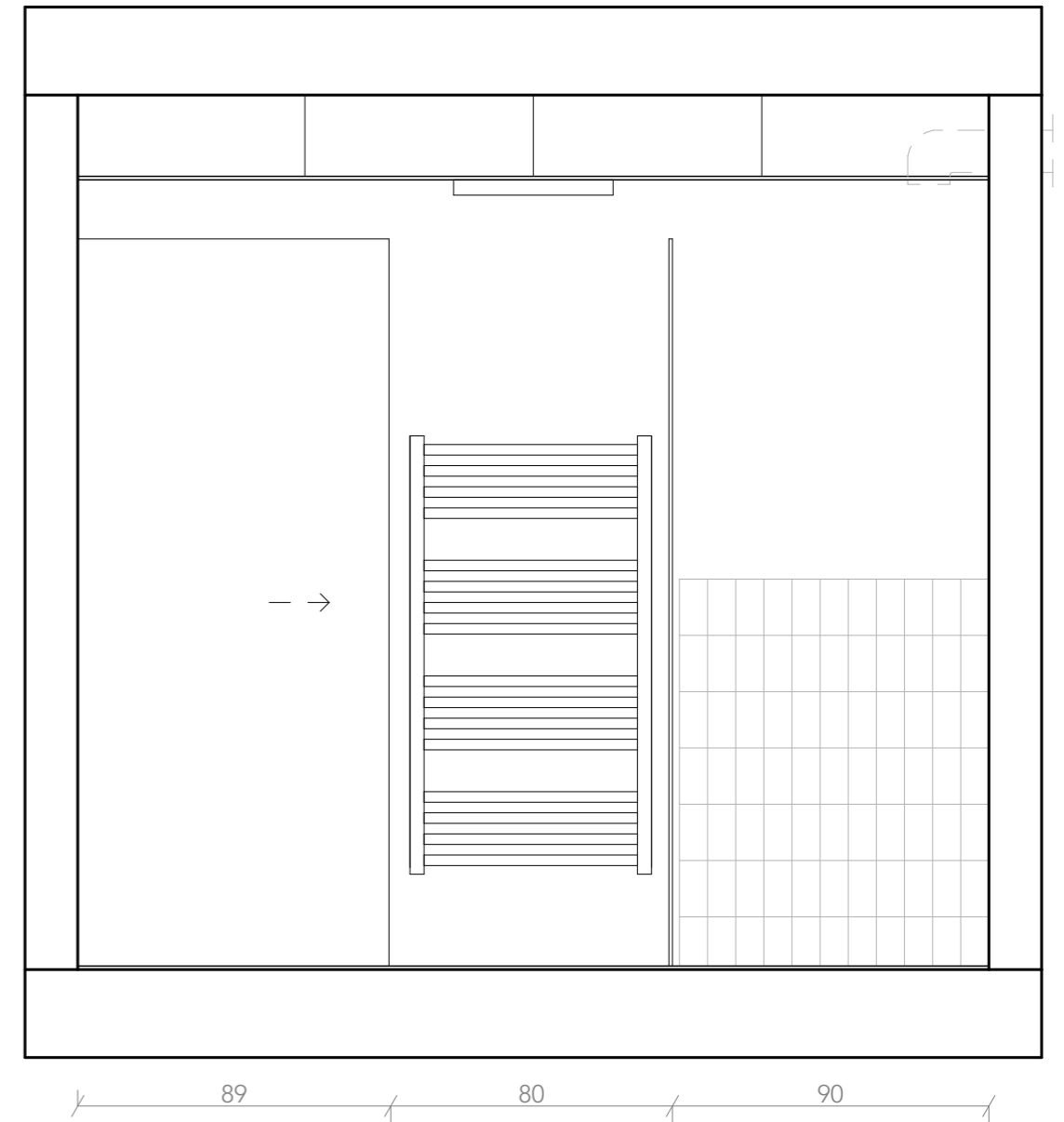
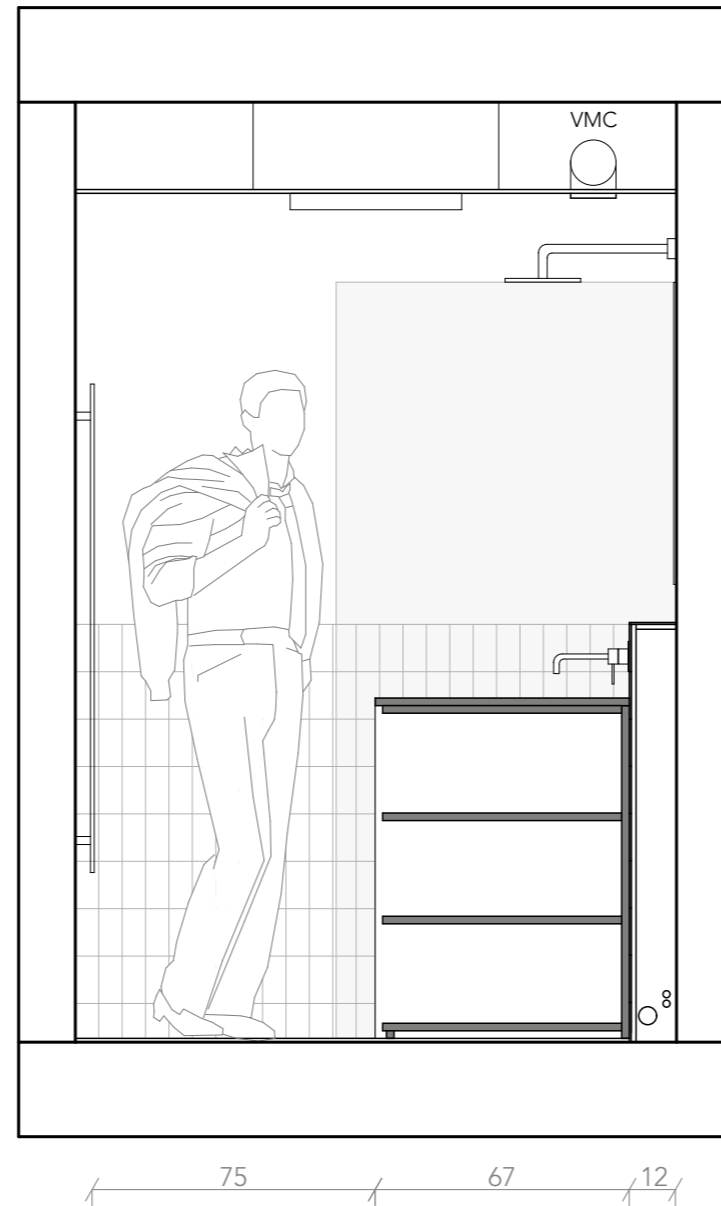
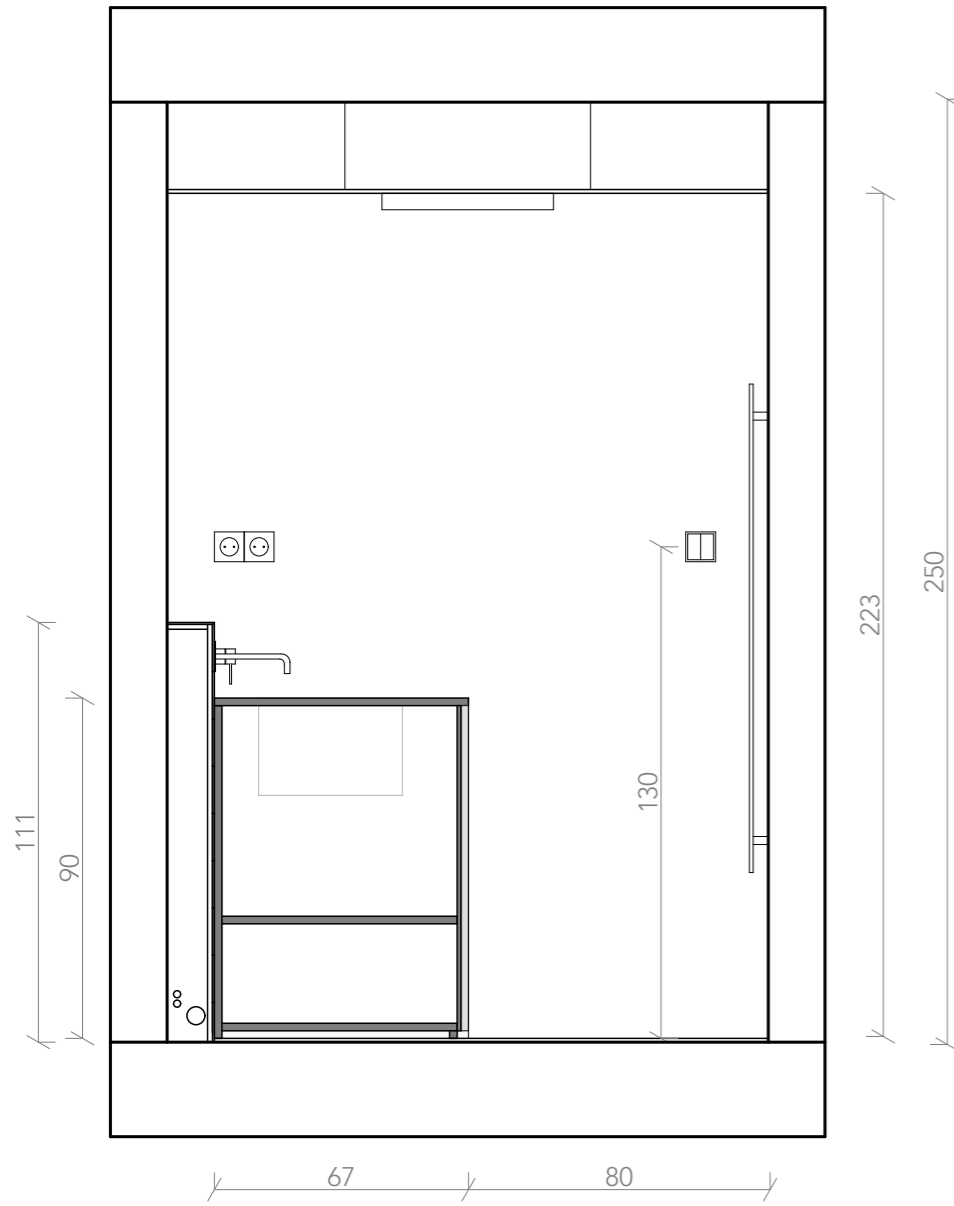

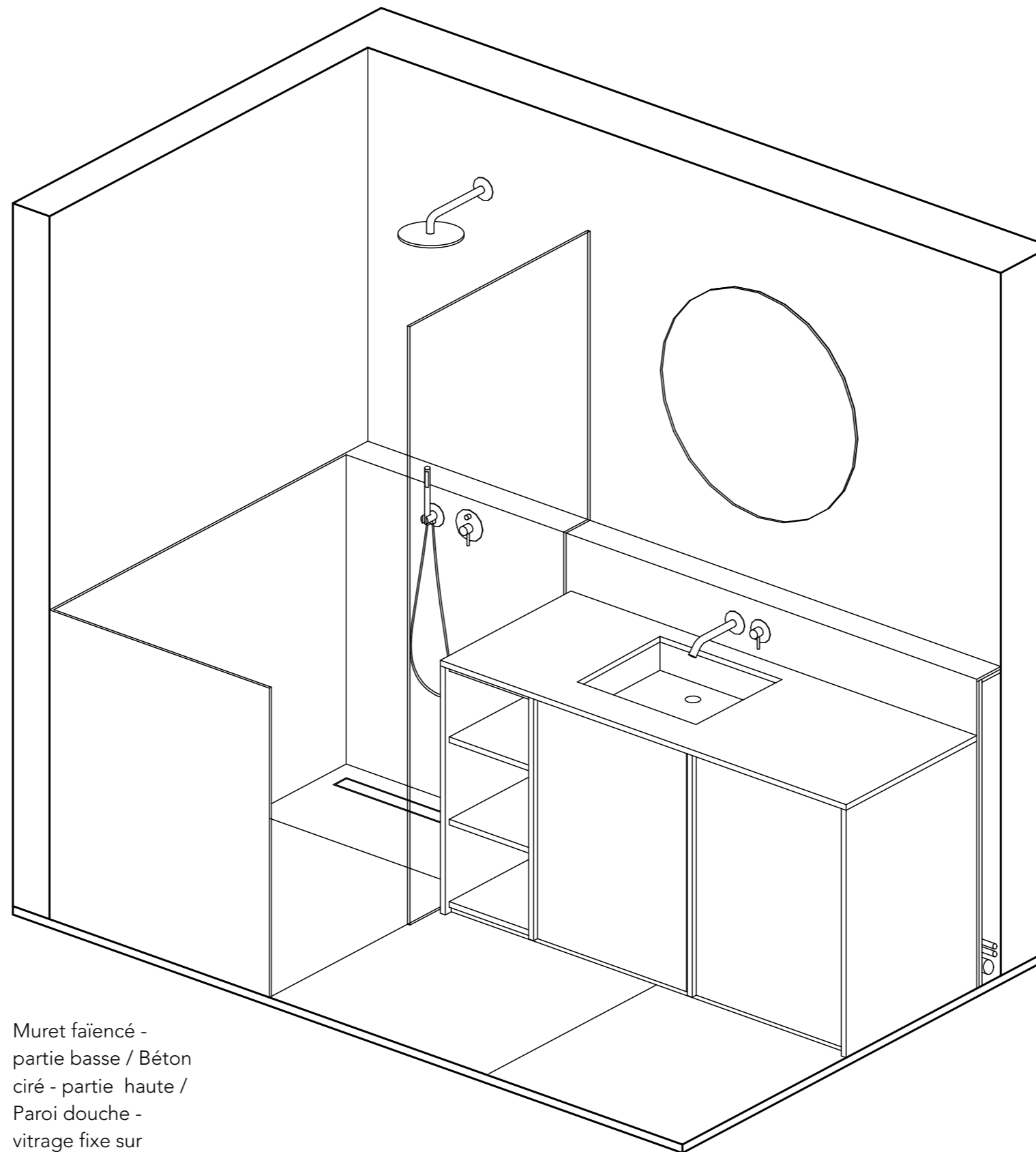

Muret faïencé -
partie basse / Béton
ciré - partie haute /
Paroi douche -
vitrage fixe sur
mesure / Mobilier
bois sur mesure

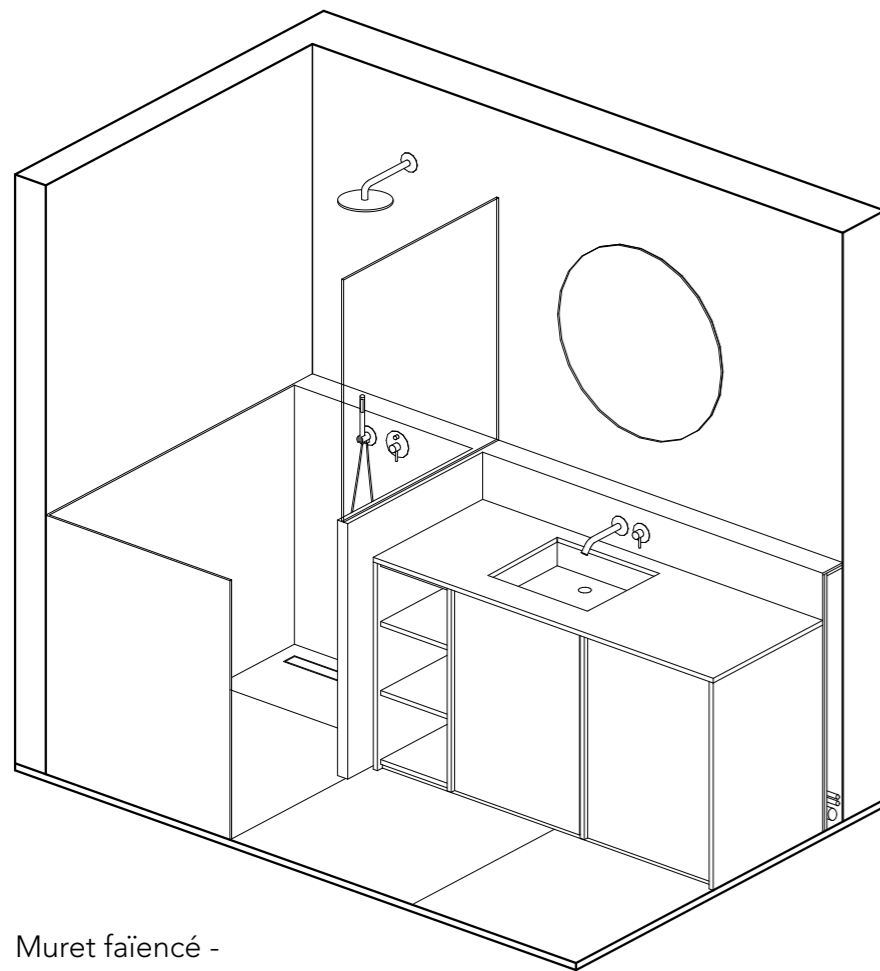

Muret faïencé -
partie basse / Vitrage
rectangulaire fixe -
partie haute

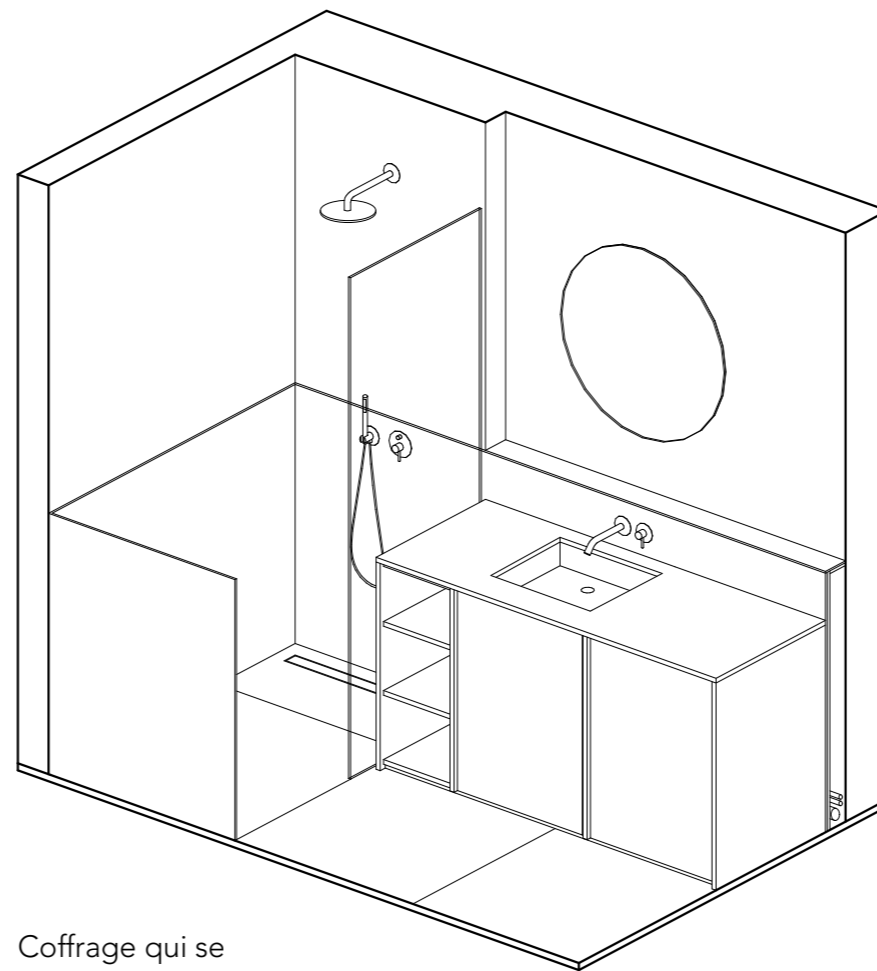

Coffrage qui se
retourne au niveau de
la douche / Vitrage
rectangulaire fixe

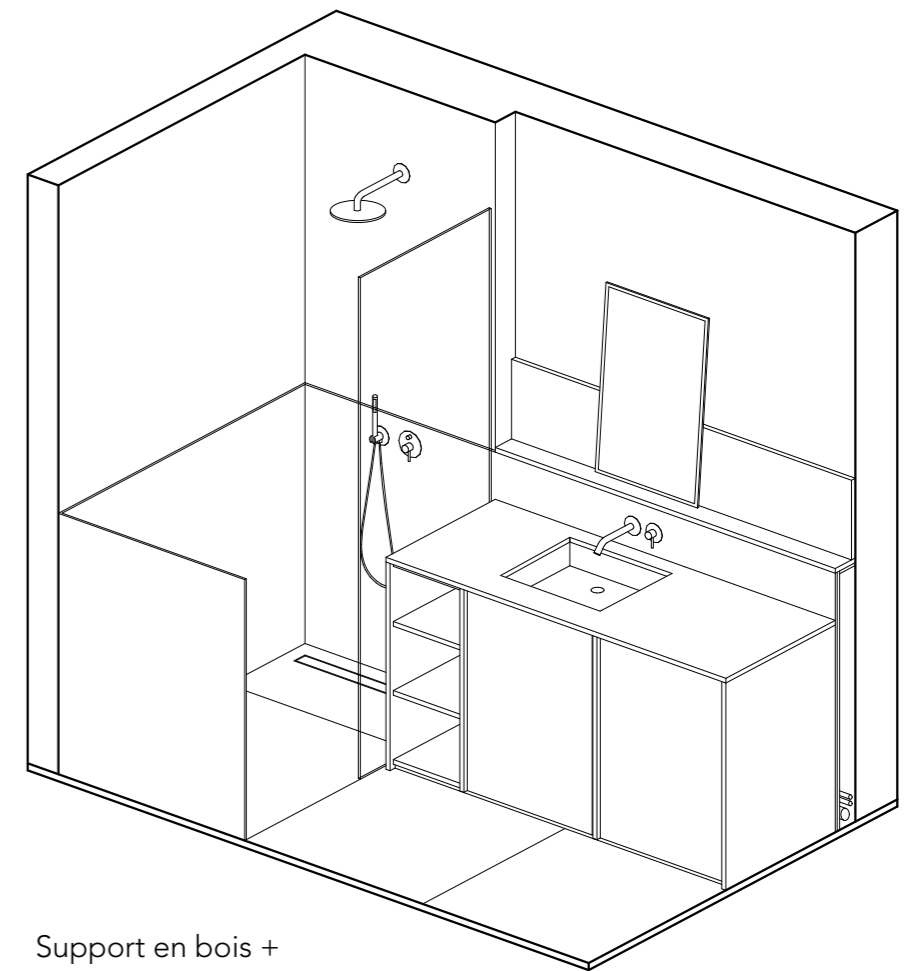

Support en bois +
Miroir posé

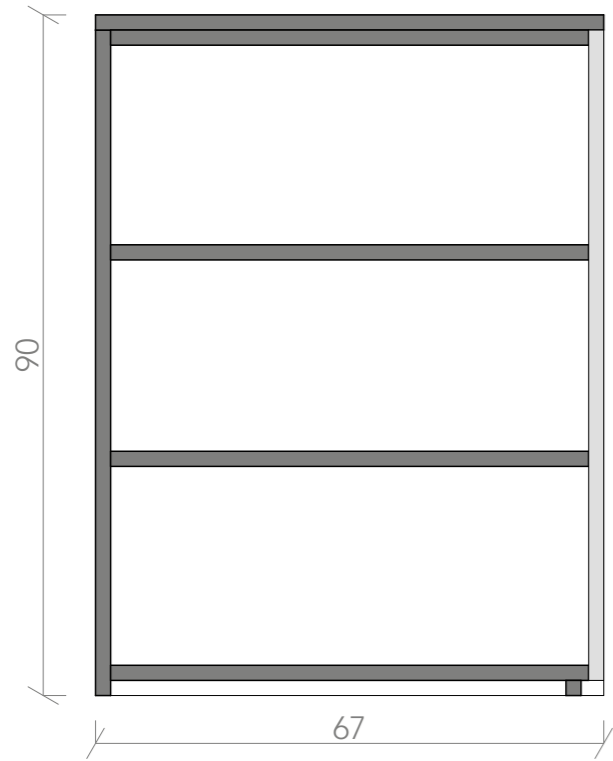

Coupe AA

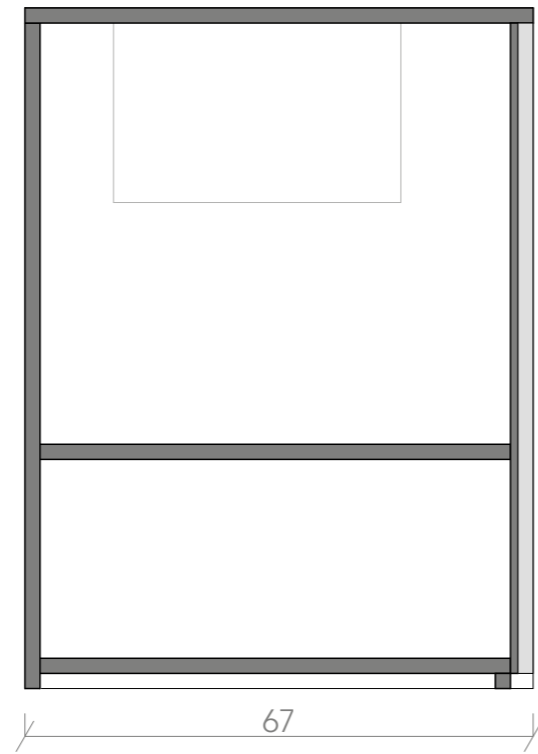

Coupe BB

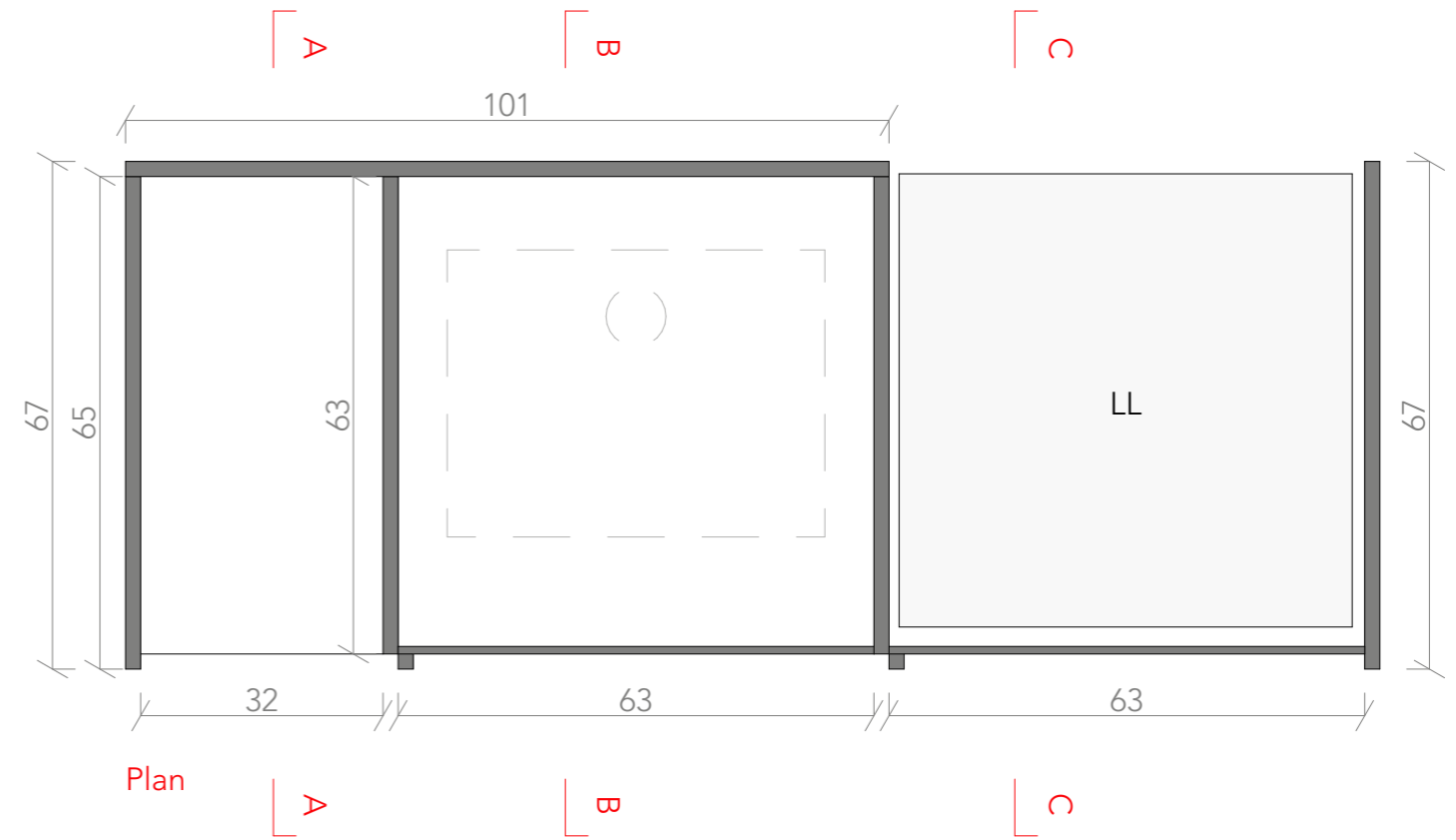

Plan

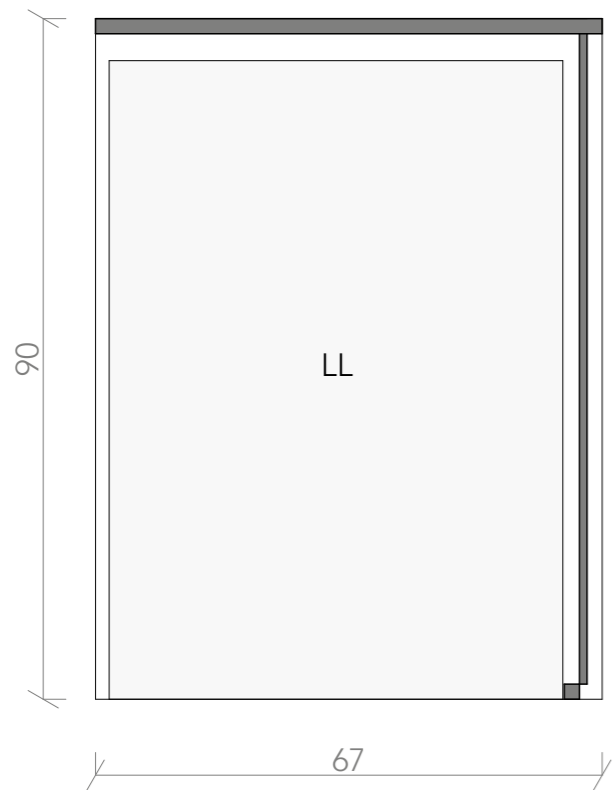

Coupe CC

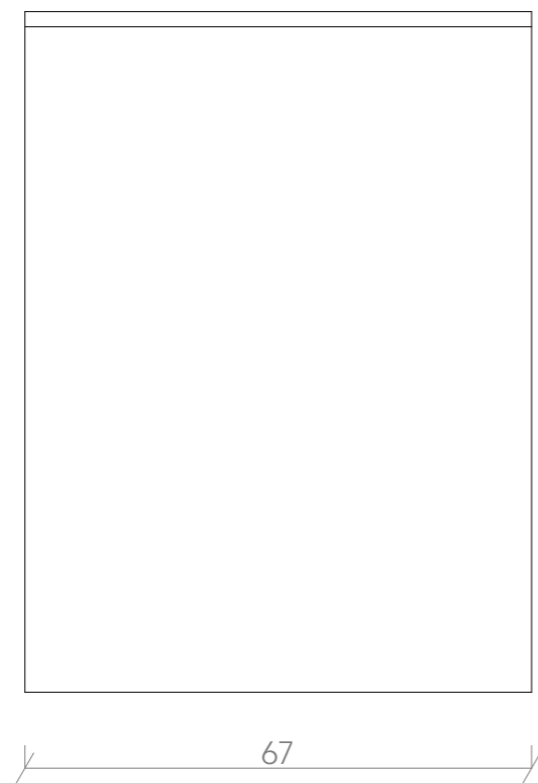

Côtés x2

Mobilier en bois pour
salle d'eau, résistant à
l'eau, sur mesure.

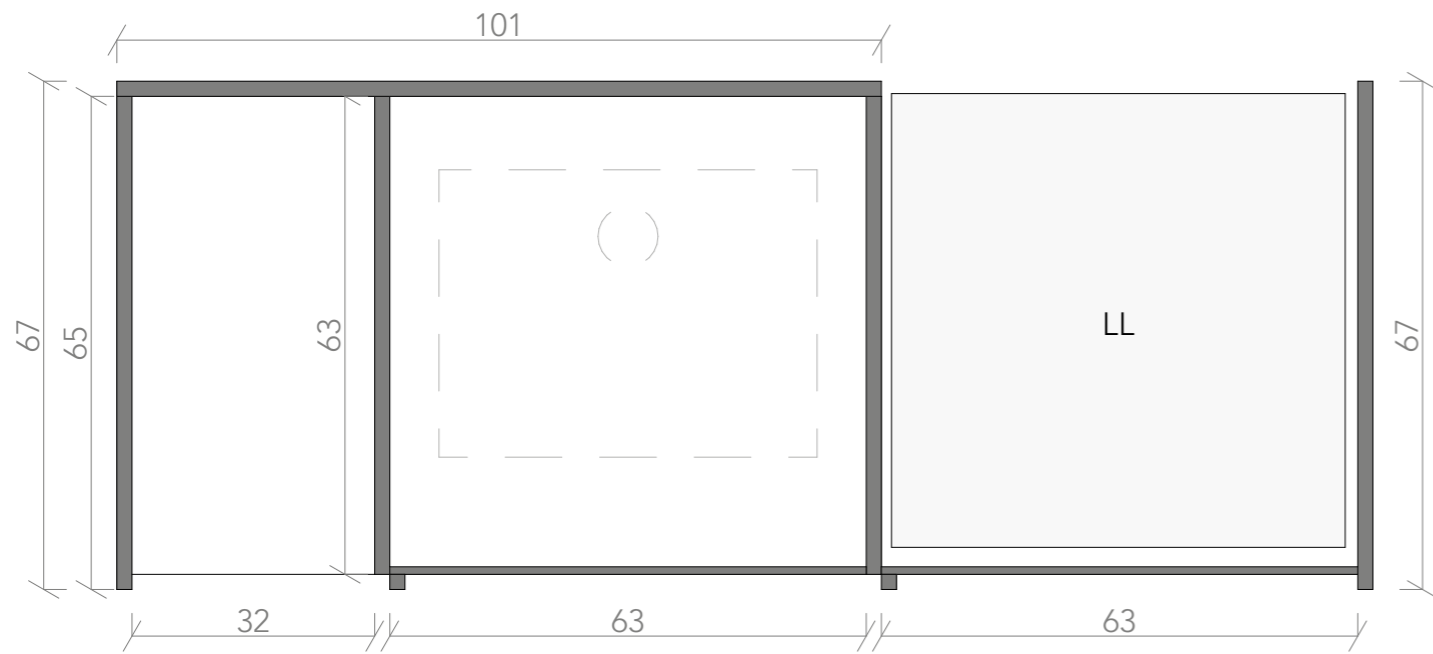

Plan

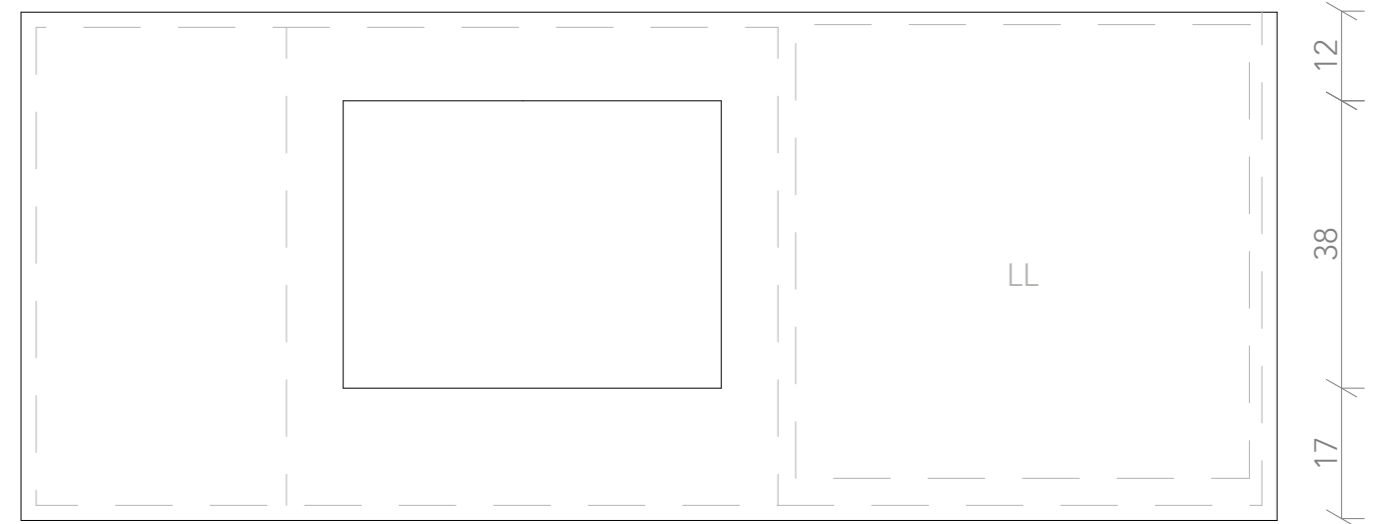

Plan de travail

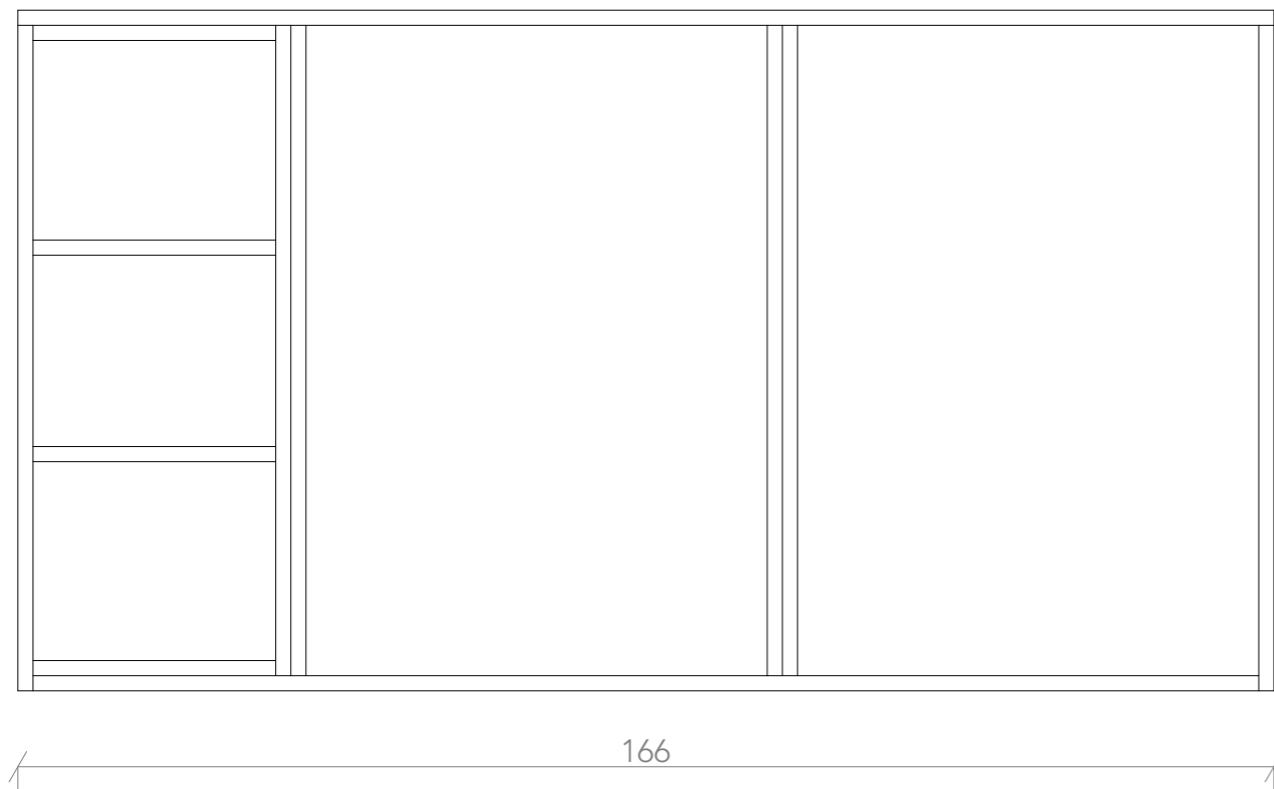

Devant

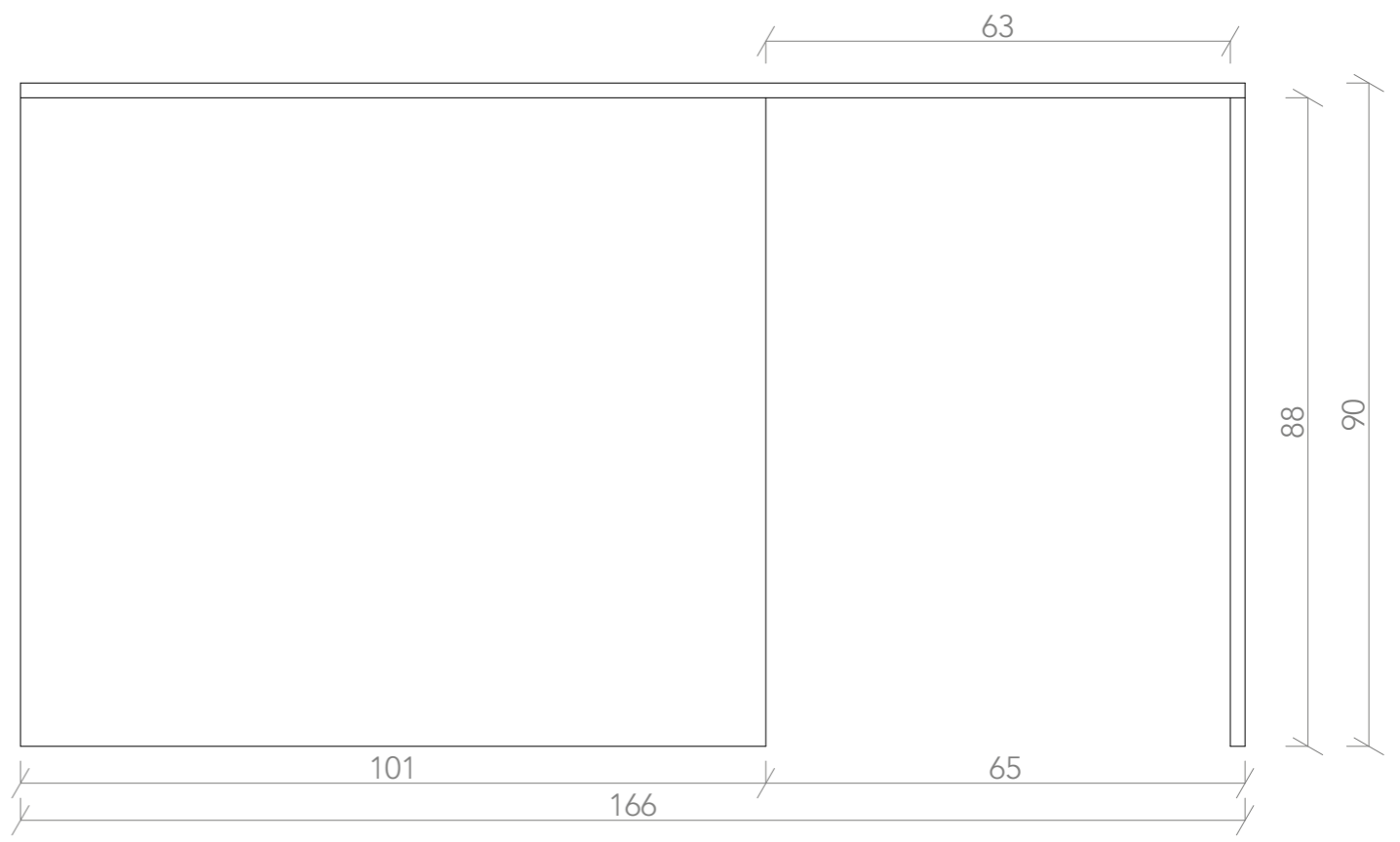

Derrière



SOL_Carrelage



MUR_Faïence crème - zellige-



MUR_Béton ciré



MOBILIER_Bois teck massif

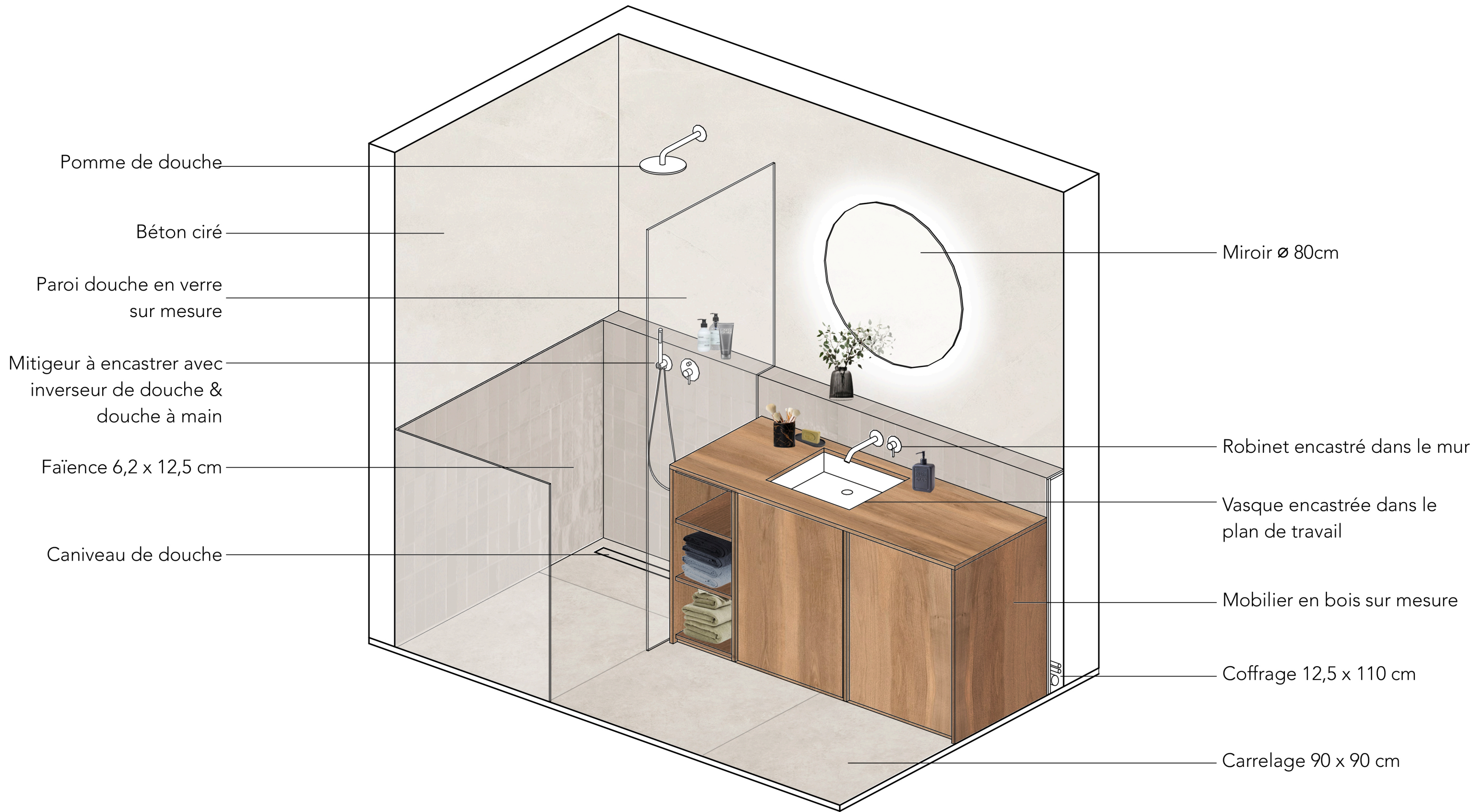



Faïence crème - zellige- / Parois de douche - exemple de verre strié - / Continuité du sol salle d'eau - douche



Système d'évacuation d'eau / Systèmes douche / Miroir

Parois de douche sur mesure - verre clair transparent - / Continuité du coffrage haut